

NOTES:

1. AISLE CLEARANCES OF AT LEAST 32" MUST BE MAINTAINED AT ALL TIMES.
2. ALL FLOOR LEVEL SEATING MUST HAVE SPIKE MARKS SHOWING PROPER LOCATION.
3. ALL SEATING MUST BE ON THE CONCRETE FLOOR. NO PLATFORMING IS ALLOWED FOR AUDIENCE SEATING.
4. ANY ALTERATIONS TO THIS SEATING PLAN MUST BE PRE-APPROVED BY THE DEPARTMENT OF THEATER & DANCE TECHNICAL DIRECTOR.

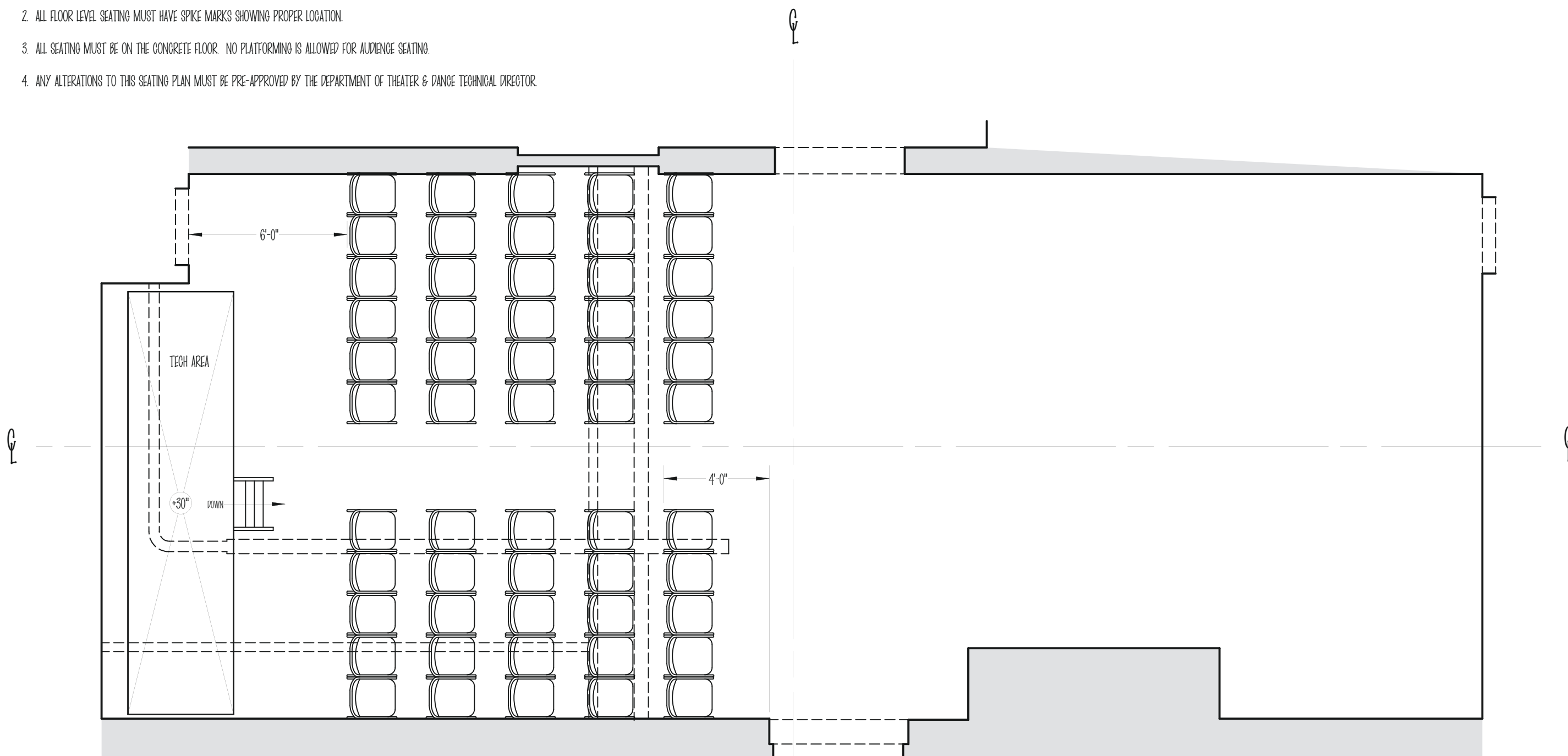

SEATING CAPACITY = 55

| | | |
|---|---------------------|--------|
| RUNNALS UNION - GOLBY COLLEGE - WATERVILLE, MAINE | | APPVD: |
| CELLAR THEATER | | SHEET |
| END ON SEATING ARRANGEMENT - PLAN VIEW | | 1 OF 1 |
| DESIGNER: JOHN D. ERVIN | DRAFT: J. D. E. | |
| REVISION DATE: 9 AUGUST 2012 | SCALE: 1/4" = 1'-0" | |