

NOTES:

1. AISLE CLEARANCES OF AT LEAST 32" MUST BE MAINTAINED AT ALL TIMES.
2. ALL FLOOR LEVEL SEATING MUST HAVE SPIKE MARKS SHOWING PROPER LOCATION.
3. ALL SEATING MUST BE ON THE CONCRETE FLOOR. NO PLATFORMING IS ALLOWED FOR AUDIENCE SEATING.
4. ANY ALTERATIONS TO THIS SEATING PLAN MUST BE PRE-APPROVED BY THE DEPARTMENT OF THEATER & DANCE TECHNICAL DIRECTOR.

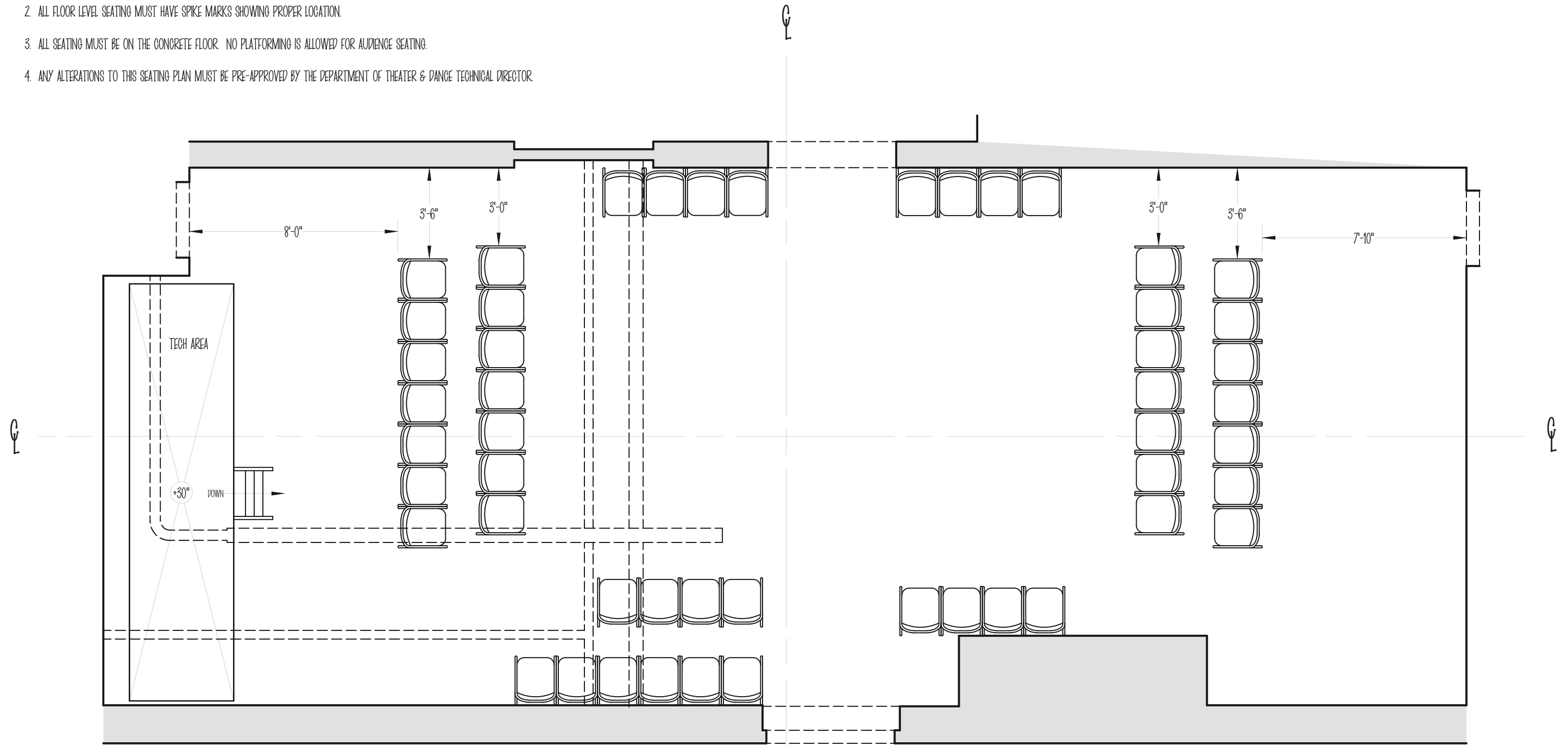

SEATING CAPACITY = 50

RUNNALS UNION - GOLBY COLLEGE - WATERTVILLE, MAINE		APPVD:
CELLAR THEATER		SHEET
ARENA SEATING ARRANGEMENT - PLAN VIEW		1 OF 1
DESIGNER: JOHN D. ERVIN	DRAFT: J. D. E.	
REVISION DATE: 9 AUGUST 2012	SCALE: 1/4" = 1'-0"	